

## Profile

- Robust and economic plastic handwheel
- Various sizes
- Hub made of zinc-coated steel for high stability and easy shaft mounting
- Various hub versions
- With thread for mounting a turning handle (see accessories)

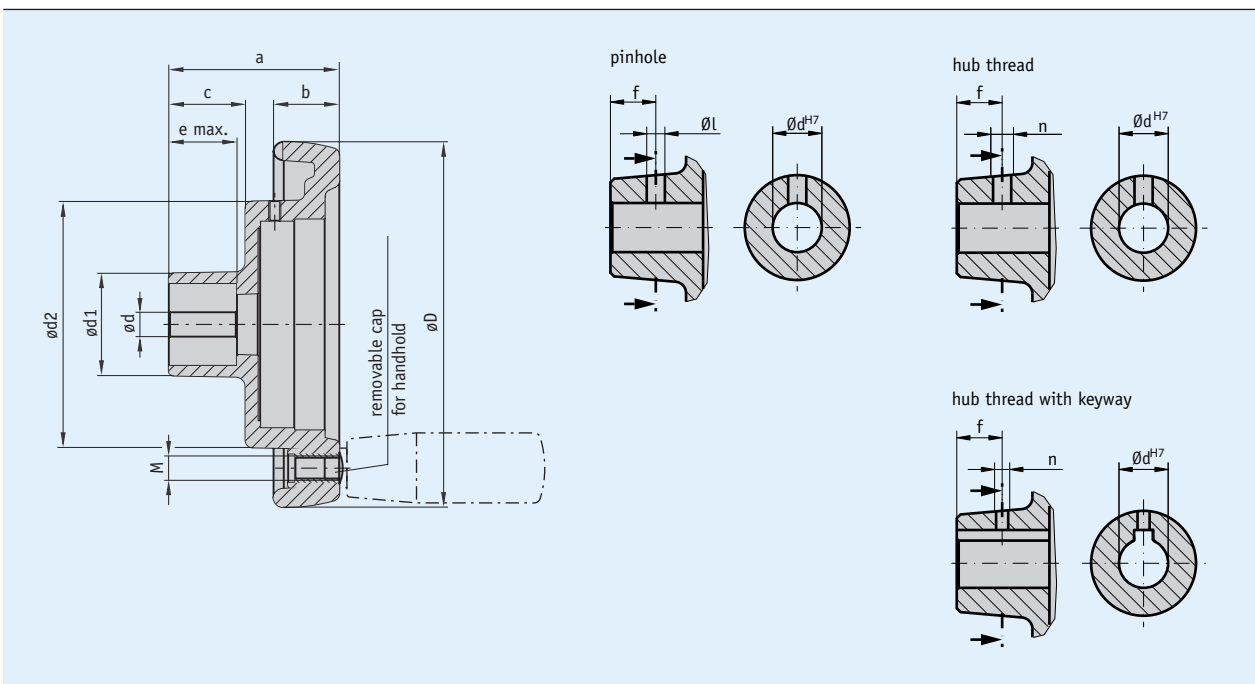

## Mechanical data

Feature	Technical data	Additional information
Material	plastic	hub of hot-dip steel
Weight	0.16 kg	KHB9
	0.35 kg	KHB13
	0.43 kg	KHB15

## ■ Maßtabelle

Type	øD	ødv	ødx	ød1	ød2	a	b	c	e	GfG	Suitable for
KHB9	87	5.8	16	32	63	54	17	21	20	M6	S50/1
KHB13	130	6.8	26	42	98.2	66	24	28.5	24	M8	S80/1; SZ80/1
KHB15	150	6.8	26	42	101	70	27	30.5	28	M10	S80/1; SZ80/1

ødv = d prebored; ødx = d max.; GfG = Thread for handle

## Sonderbearbeitung

Handwheel type	KHB9						KHB13 / KHB15					
	6 ... 8	9, 10	11, 12	13, 14	15, 16	7, 8	9, 10	11, 12	13 ... 17	18 ... 20	21 ... 24	25, 26
Bore dH7												
Groove width with keyhole JS9		3	4				3	4	5	6		
Pin hole	3.8/8	3.8/8	3.8/8	4.8/8		3.8/12	3.8/12	3.8/12	4.8/12	4.8/12	4.8/12	
Hub thread without keyhole JS9	M4/8	M4/8	M4/8	M6/8		M4/12	M4/12	M4/12	M6/12	M6/12	M6/12	
Hub thread with keyhole JS9		M3/8	M3/8				M3/12	M3/12	M4/12	M5/12		

Texts highlighted in orange color are ordering features

## Order

### Ordering information

One or more system components are required:

Analog position indicator S50/1

[www.siko-global.com](http://www.siko-global.com)

Analog position indicator S80/1

[www.siko-global.com](http://www.siko-global.com)

Analog position indicator SZ80/1

[www.siko-global.com](http://www.siko-global.com)

### Ordering table

Feature	Ordering data	Specification	Additional information	
handwheel type	9	A KHB9		
	13			
	15			
Bore diameter	5.8	B prebored	only with KHB9	
	6.8		only with KHB13, KHB15	
	...		6 ... 26 mm, in steps of 1 mm see Table of dimensions, maximum value ødx	
Feather key groove	OP	C without keyway	according to DIN 6885/1 T1	
	JS9			light seat
Pinhole	OS	D without pin hole	see table Special processing, depending on the handwheel type, only if keyway is "OP", only if hub thread is "ONG"	
	...			diameter "øl"/measure "f" (e.g. 3.8/12)
				others on request
Hub thread	ONG	E without hub thread	see table Special processing, depending on the handwheel type, only if pin hole is "OS"	
	...			thread "n"/measure "f" (e.g. M4/12)
				others on request
Position indicator	PM	F position indicator mounted	separate ordering of a position indicator required!	
	PS		position indicator separate	separate ordering of a position indicator required!
Tapered hub	OAN	G without turned hub	only with KHB9	
		others on request		

### Order key



Scope of delivery: KHB...

#### Accessories:

Handwheel holder BGF

[www.siko-global.com](http://www.siko-global.com)

Handwheel holder UG

[www.siko-global.com](http://www.siko-global.com)

Handwheel holder ZGD

[www.siko-global.com](http://www.siko-global.com)

Handwheel holder BGD

[www.siko-global.com](http://www.siko-global.com)

End Plate AD

[www.siko-global.com](http://www.siko-global.com)