

Profile

- Extremely sturdy design in a metal housing
- Hollow shaft, max. \varnothing 35 mm
- Counter with 4 or 5 decades
- with zeroing function
- Clamp lever integrated in the design
- Stainless-steel driving shaft as an option
- Reversible counting direction

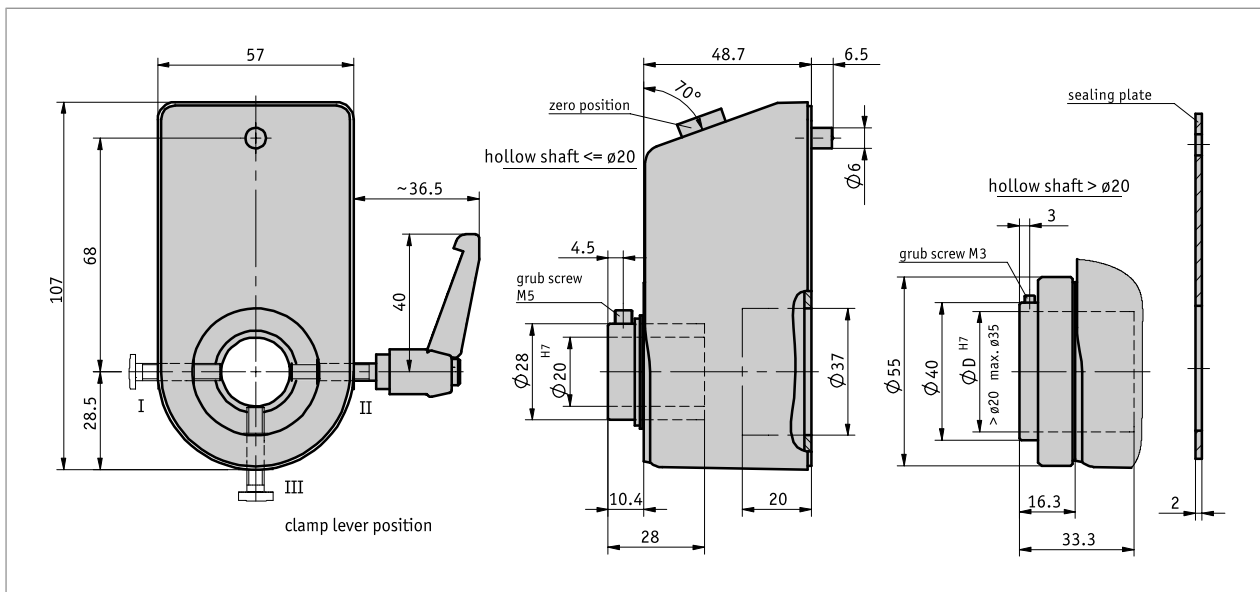

Mechanical data

Feature	Technical data	Additional information
Housing	zinc die-cast	
Counter	4 Decades with fine reading	
Digit height	~4,5 mm	
Weight	0.7 kg	

max. speed

Display (after 1st revolution)	max. speed [rpm] with zero position	max. speed [min-1] without zero setting
(0)0010	500	500 (1200)
(0)0020	250	500 (600)
(0)0025	200	480
(0)0030	165	400
(0)0040	125	300
(0)0050	100	240
(0)0060	85	200
(0)0080	60	150
(0)0100	50	120

 Speeds >500 rpm must only be run for short periods.

Formula:

with zero position

$$\text{max. speed} = \frac{5000}{\text{indication after 1st revolution}}$$

without zero position





$$\text{max. speed} = \frac{12000}{\text{indication after 1st revolution}}$$

Ambient conditions

Feature	Technical data	Additional information
Ambient temperature	0 ... 80 °C	

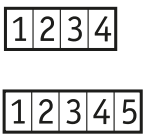
Order

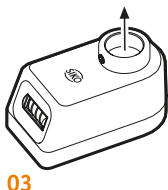
Ordering information

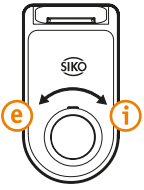
Display	Mounting position with zero position		Mounting position without zero position		Counting direction
	 01	 03	 02	 04	

Note: Highlights in orange are order features.

Ordering table

Feature	Ordering data	Spezifikation	Additional information
Mounting position	A 01	with zero position	see the icons illustrating the mounting positions
	02	without zero position	see the icons illustrating the mounting positions
	03	with zero position	see the icons illustrating the mounting positions
	04	without zero position	see the icons illustrating the mounting positions
Counter/digits	B 4	4 decades	
	5	5 decades	
indication after 1st revolution	C ...	10, 16, 20, 30, 40, 50, 60, 80, 100 others on request	
decimal place	D 0	0 = 00000	only with 5 decades
	1	1 = 0000.0	
	2	2 = 000.00	only with 5 decades
	3	3 = 00.000	only with 5 decades
	4	4 = 0.0000	only with 5 decades
Counting direction	E i	clockwise ascending values	
	e	counter-clockwise ascending values	
	e/i	can be adjusted by the customer	by opening the housing

In the metal housing

Feature	Ordering data	Spezifikation	Additional information
hollow shaft/diameter	F	20	ø20 mm
		35	ø35 mm
		VA20	ø20 mm
		...	RH10, RH12, RH14, RH16, RH18
			only with display after 1st rotation "50" stainless steel reducing bushes
Color	G	0	orange RAL 2004
		S	black RAL 9005
clamp lever/position	H	OKL	without locking lever
		I	position I
		II	position II
		III	position III

■ Order key

DA08 - - - - - - - -

A B C D E F G H

	Scope of delivery: DA08
	Accessories you can find: Adapter sleeve RH

www.siko-global.com