

Made in Germany

# ATEK

ANTRIEBSTECHNIK

Das Winkelgetriebe



- Miniature bevel gearboxes
- Bevel gearboxes
- Hygiene-design gearboxes
- Hybrid gearboxes
- Worm gearboxes
- Gearbox motors
- Servo gearboxes (precision gearboxes)
- Special gearboxes
- ATEX gearboxes
- Gear sets
- Service

Examination of gearboxes  
Cost estimates for repairs and alterations  
Handling of complaints  
Preparation of spare part offers  
Technical assistance on ATEK gearboxes



## General information

---

## Spare parts

---

## Lubricant table

---

## Local contacts

## 15.1 General information

Our service department will help you with technical assistance with regard to the ATEK gearboxes, prepare spare parts offers for you, and examine gearboxes. The department will prepare cost estimates for repairs and alterations, and support you in the handling of complaints.

We will be able to help you faster and to ascertain the required information more accurately if you communicate the serial number or the order number with the gearbox designation to us. You can find the serial number and the gearbox designation on the type plate.



The repair effort can often be determined only after a thorough examination. In such a case, we recommend to send us your gearbox. This will also apply in the case of a complaint when we have to determine the cause of the failure.

Prior to the shipment, the vent filters have to be removed, and the threaded holes must be plugged with dummy plugs. Additionally, all mounted add-on parts must be removed.

**Free delivery to:**  
ATEK Antriebstechnik Willi Glapiak GmbH  
Service  
Siemensstraße 47  
D-25462 Rellingen

**Contact:**  
E-mail: [service@atek.de](mailto:service@atek.de)  
Phone: +49 (0)4101 7953-0

## 15.3 Spare parts

It is principally possible to purchase spare parts by specifying the serial number.

The serial number enables us to identify the originally delivered parts as part of the traceability and to deliver appropriately.

For spare part enquiries or orders, please use the following drawings of the individual gearbox types for the identification of the required parts.

Note: We cannot assume any warranty for the proper execution of a repair by the operator or any third party and for the functioning of the gearbox. We therefore recommend to send us the gearboxes for repair.

## 15.3 Spare parts

Type V

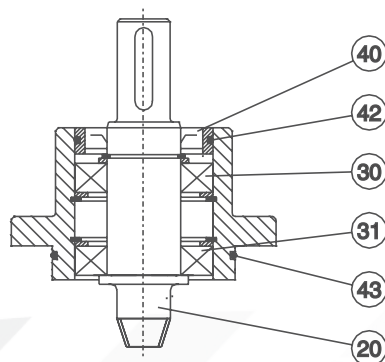
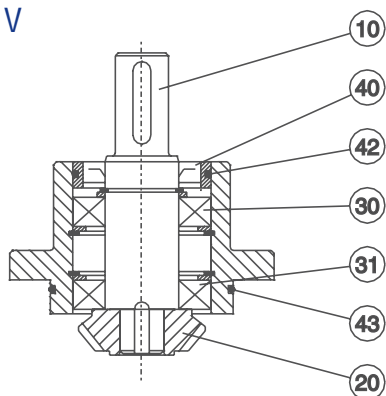

Construction type A (F)

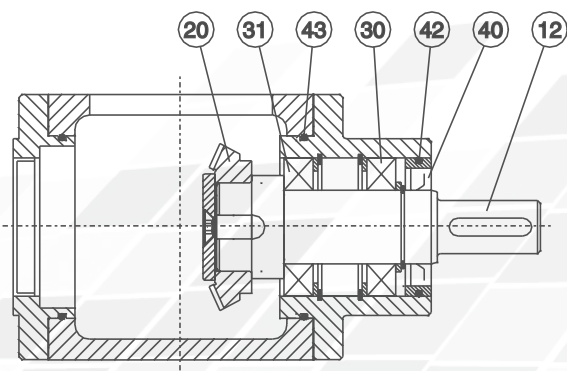

Construction type B (G)

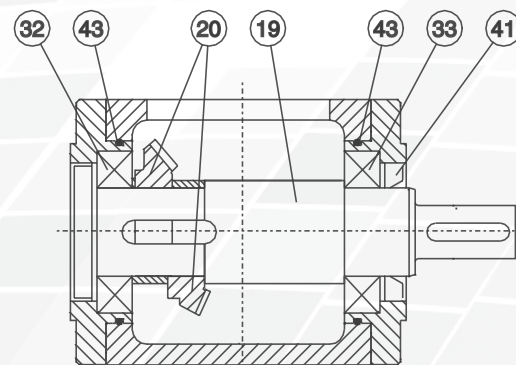

Construction type C (H)

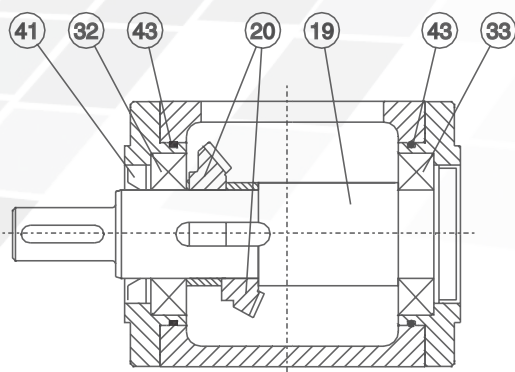

Construction type D (J)

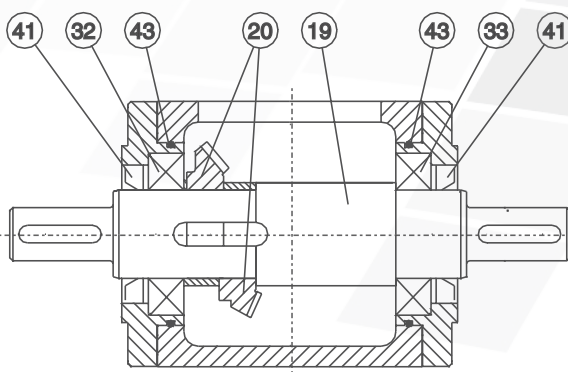

No.	Designation
10	Drive shaft
12	Output shaft
19	Output shaft
20	Bevel gear set
30	Roller bearing
31	Roller bearing

No.	Designation
32	Roller bearing
33	Roller bearing
40	Radial seal
41	Radial seal
42	O-ring
43	O-ring

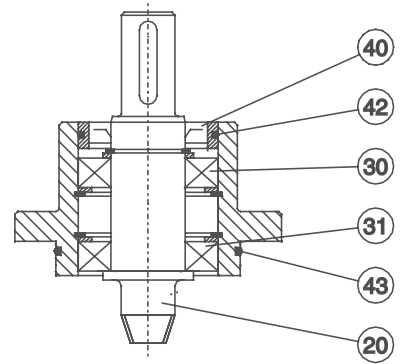
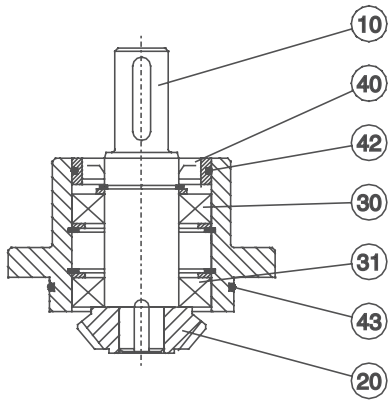

**Construction type E (K)**

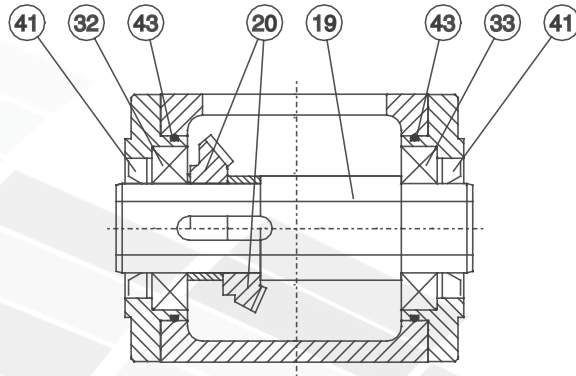

**Construction type E (K) - S5**

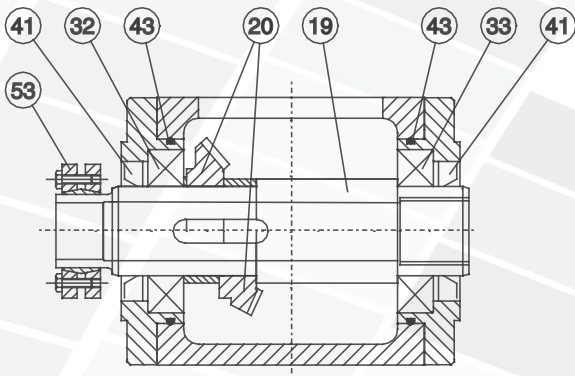

**Construction type E (K) - S6**

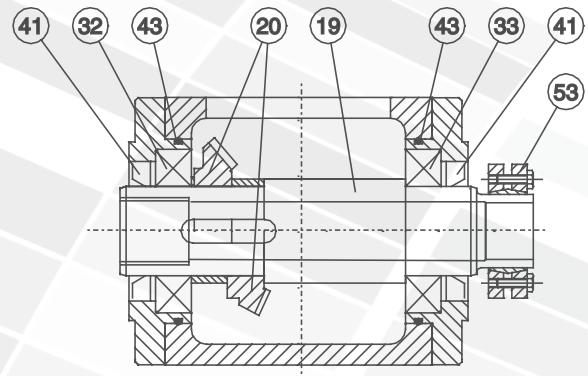

No.	Designation
10	Drive shaft
19	Drive shaft
20	Bevel gear set
30	Roller bearing
31	Roller bearing
32	Roller bearing

No.	Designation
33	Roller bearing
40	Radial seal
41	Radial seal
42	O-ring
43	O-ring
53	Clamping set



## 15.3 Spare parts

Type VL/VLM

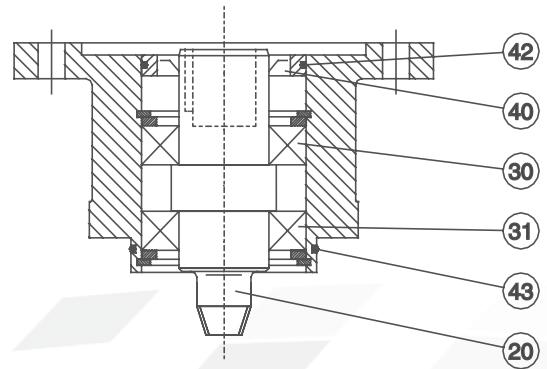
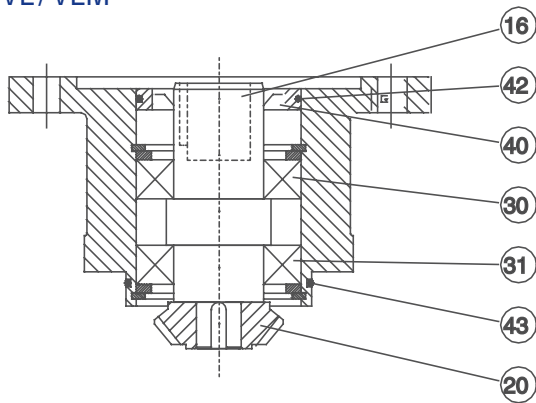

Construction type A (F)

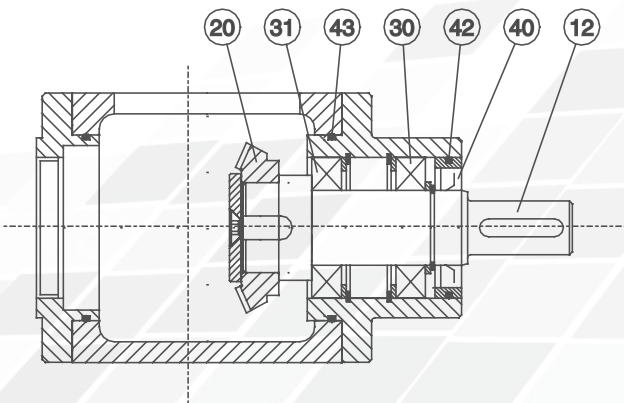

Construction type B (G)

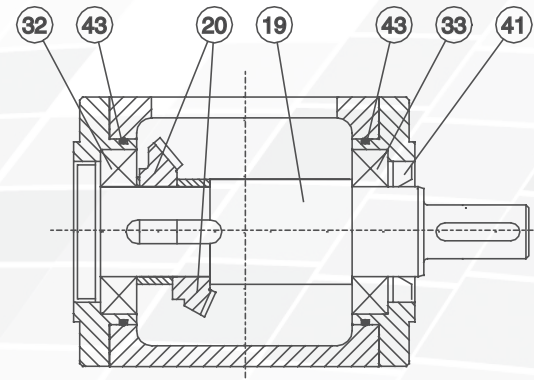

Construction type C (H)

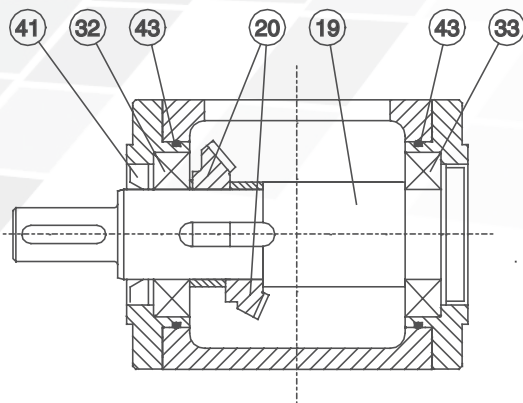

Construction type D (J)

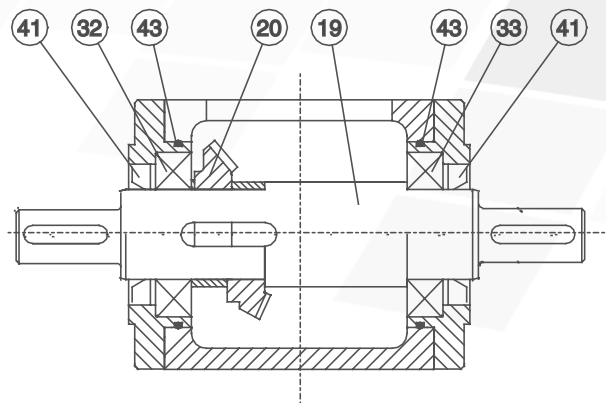

No.	Designation
12	Output shaft
16	Drive shaft
19	Output shaft
20	Bevel gear set
30	Roller bearing
31	Roller bearing

No.	Designation
32	Roller bearing
33	Roller bearing
40	Radial seal
41	Radial seal
42	O-ring
43	O-ring

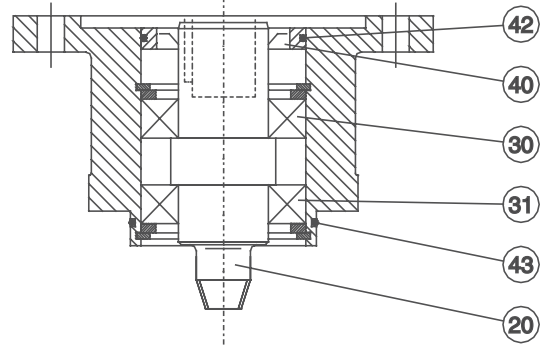
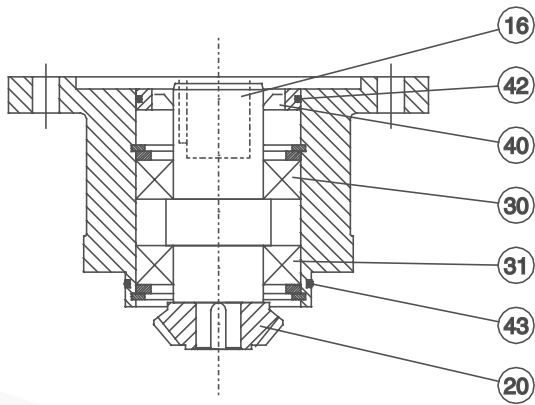

### Construction type E (K)

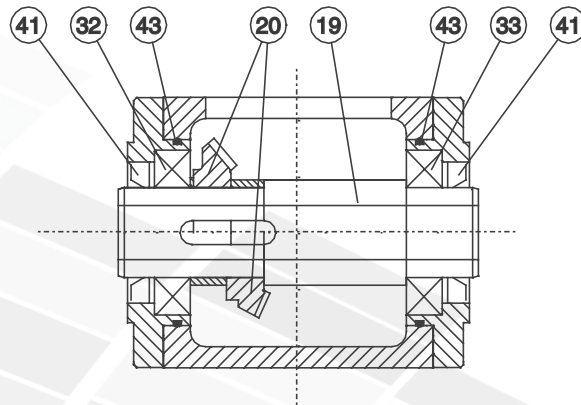

### Construction type E (K) - S5

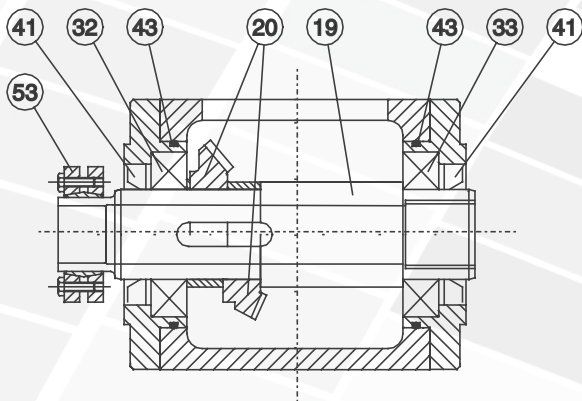

### Construction type E (K) - S6

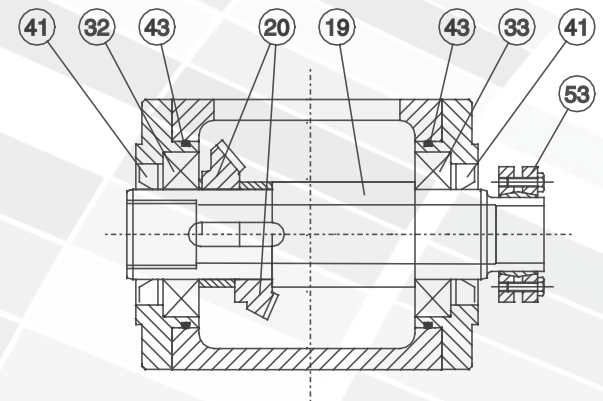

No.	Designation
16	Drive shaft
19	Output shaft
20	Bevel gear set
30	Roller bearing
31	Roller bearing
32	Roller bearing

No.	Designation
33	Roller bearing
40	Radial seal
41	Radial seal
42	O-ring
43	O-ring
53	Clamping set

## 15.3 Spare parts

Type VC

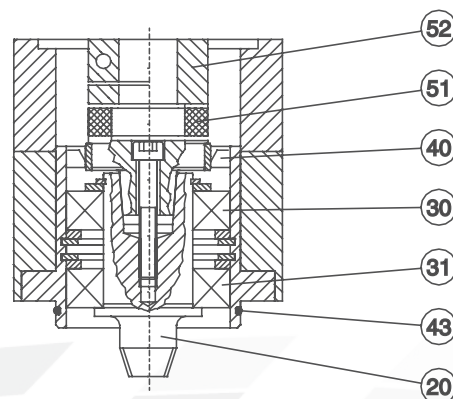
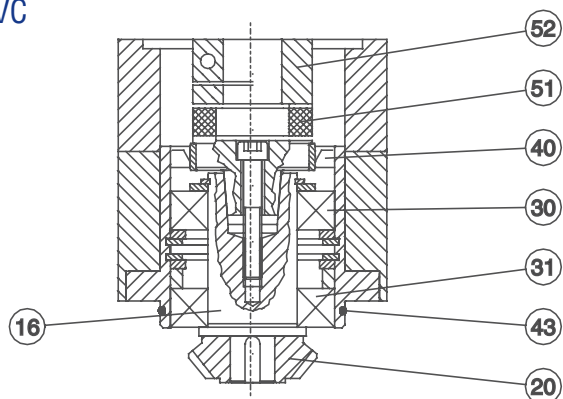

Construction type A (F)

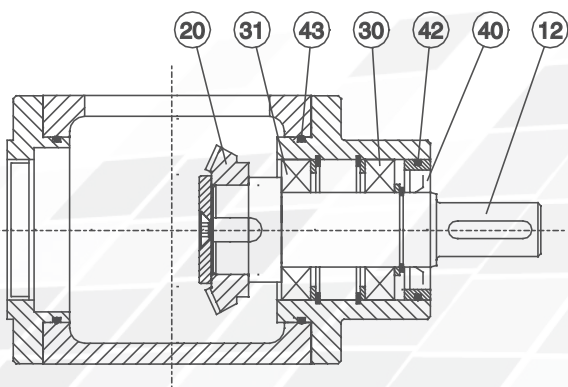

Construction type B (G)

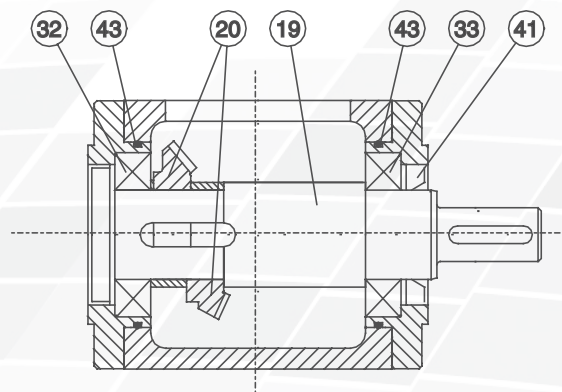

Construction type C (H)

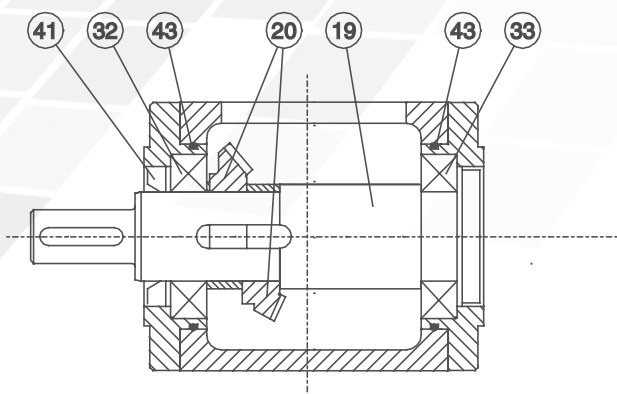

Construction type D (J)

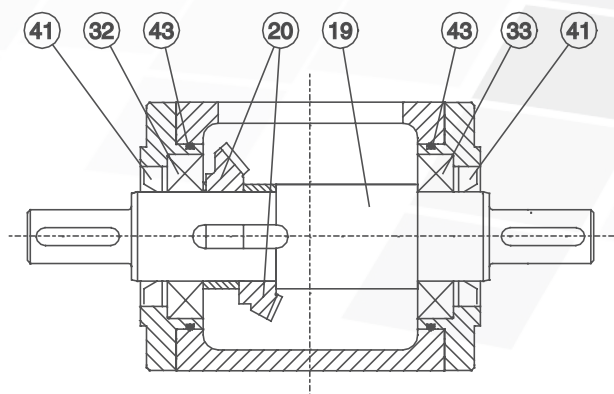

No.	Designation
12	Output shaft
16	Drive shaft
19	Output shaft
20	Bevel gear set
30	Roller bearing
31	Roller bearing
32	Roller bearing

No.	Designation
33	Roller bearing
40	Radial seal
41	Radial seal
42	O-ring
43	O-ring
51	Toothed ring
52	Coupling



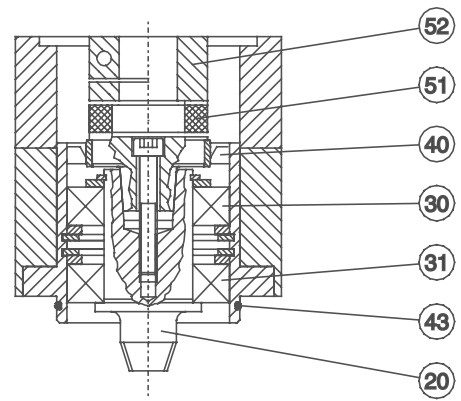
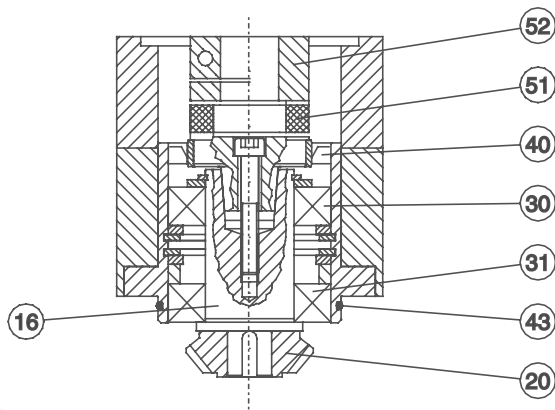

### Construction type E (K)

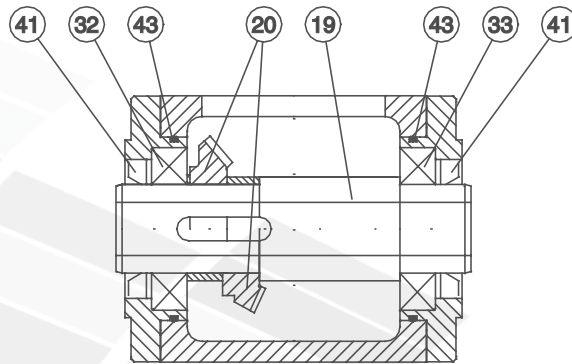

### Construction type E (K) - S5

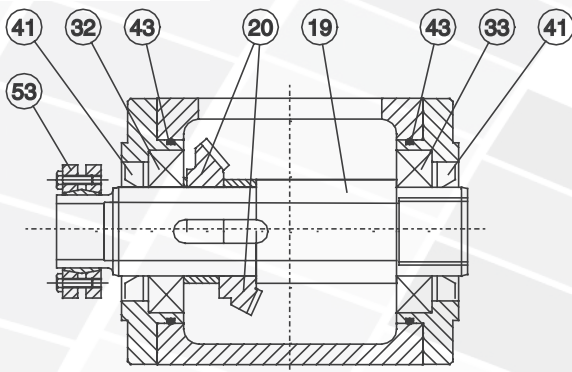

### Construction type E (K) - S6

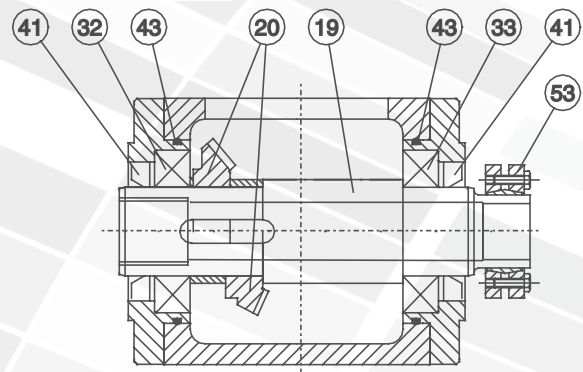

No.	Designation
16	Drive shaft
19	Output shaft
20	Bevel gear set
30	Roller bearing
31	Roller bearing
32	Roller bearing
33	Roller bearing

No.	Designation
40	Radial seal
41	Radial seal
42	O-ring
43	O-ring
51	Toothed ring
52	Coupling
53	Clamping set

## 15.3 Spare parts

Type VS

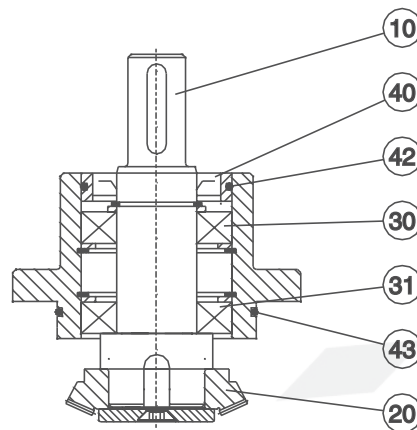

Construction type D.

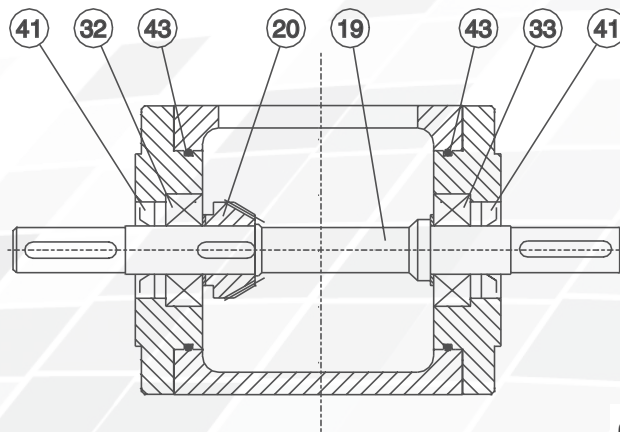

Construction type B.

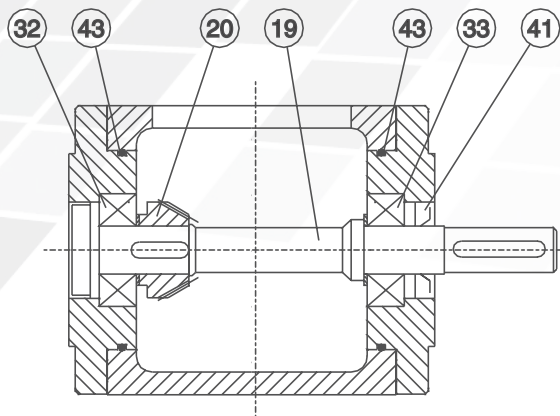

Construction type C.

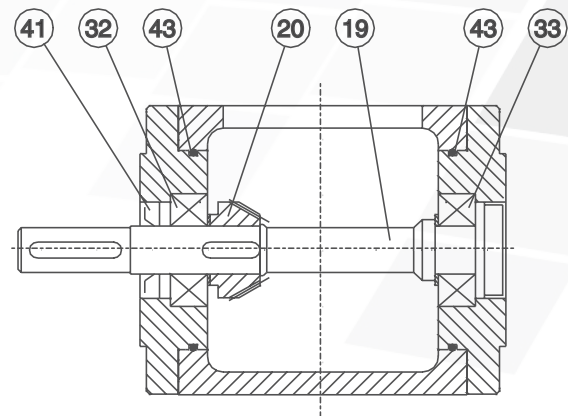

No.	Designation
10	Drive shaft
19	Output shaft
20	Bevel gear set
30	Roller bearing
31	Roller bearing
32	Roller bearing

No.	Designation
33	Roller bearing
40	Radial seal
41	Radial seal
42	O-ring
43	O-ring

## Type S 040 – 100

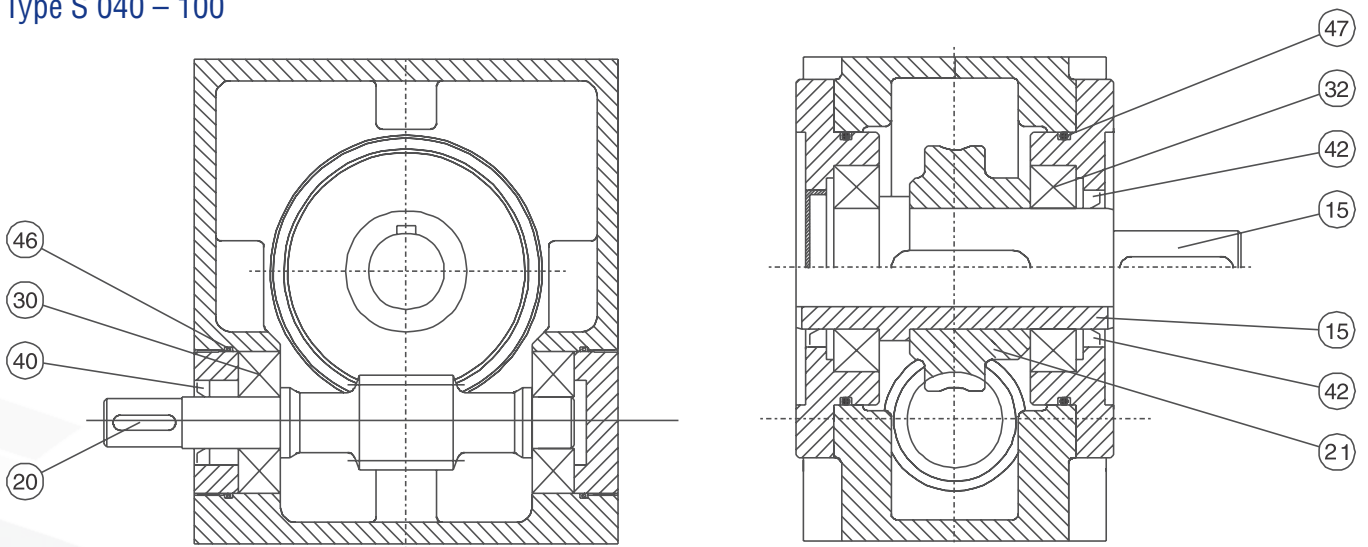

## Type S 125 – 250

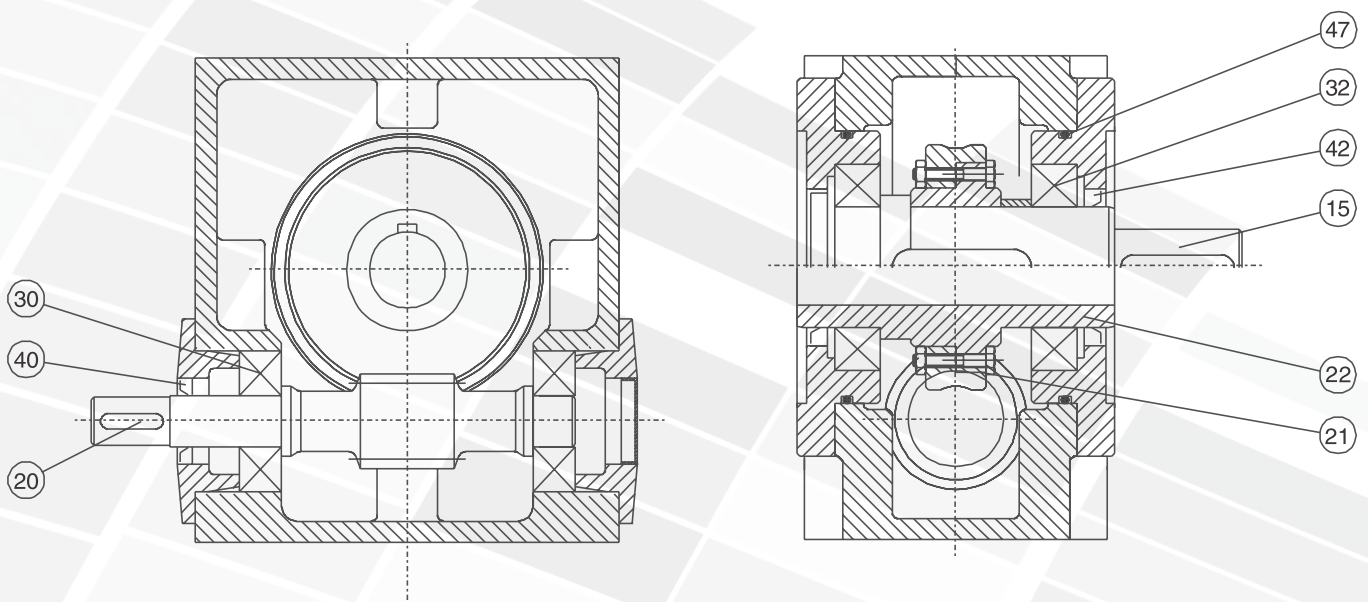

No.	Designation
15	Output shaft
20	Worm
21	Worm gear
22	Hub
30	Roller bearing

No.	Designation
32	Roller bearing
40	Radial seal
42	Radial seal
46	O-ring
47	O-ring

## 15.3 Spare parts

Type SL/SLM 040 – 100

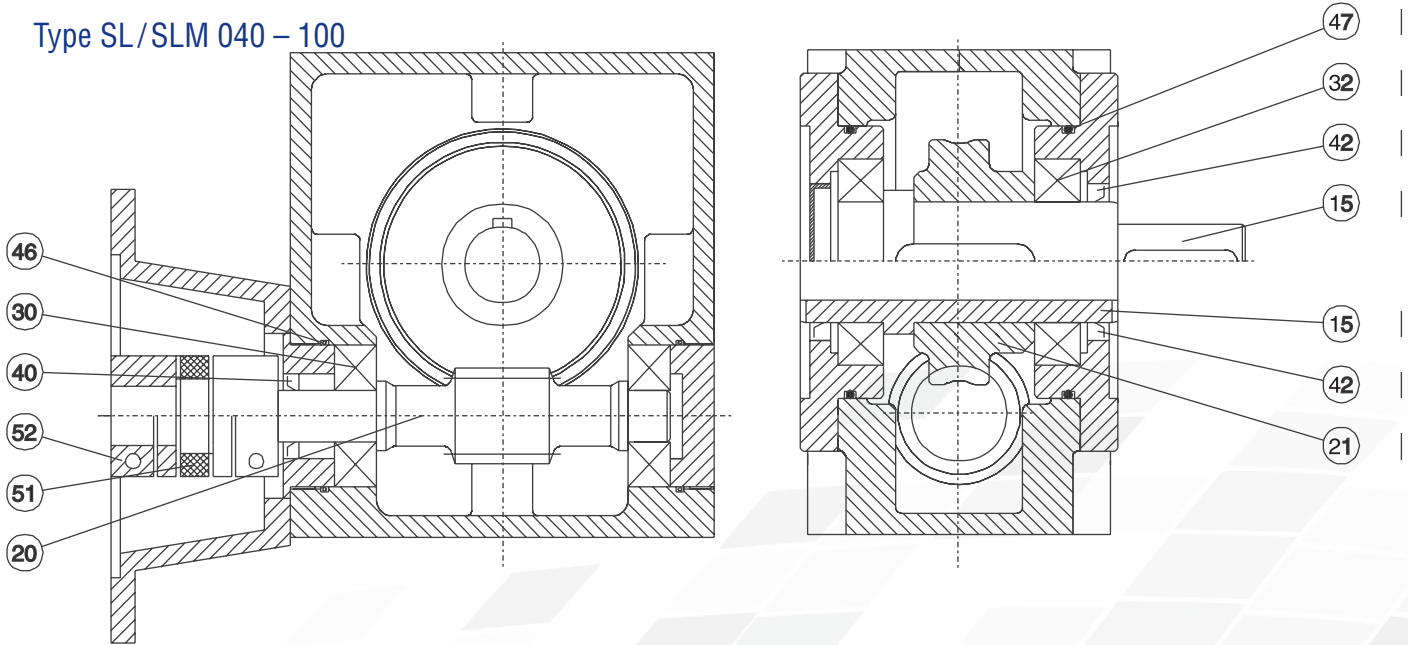

Type SL/SLM 125 – 250

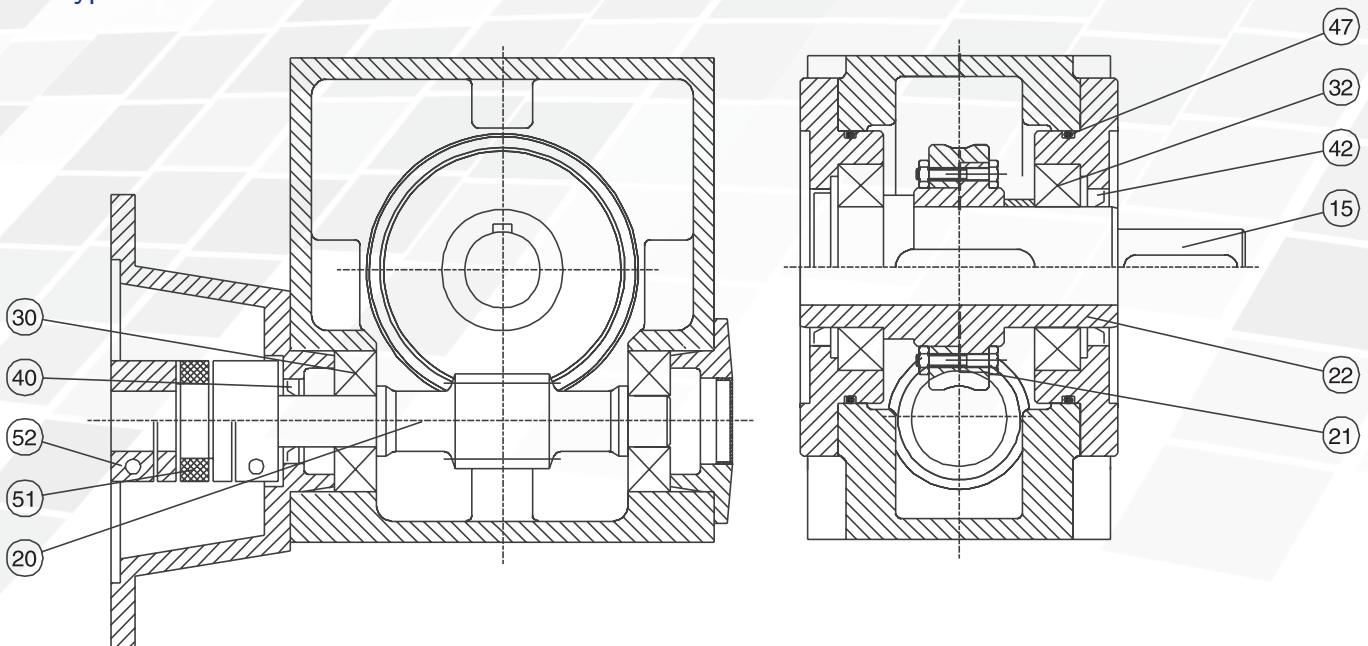

No.	Designation
15	Output shaft
20	Worm
21	Worm gear
22	Hub
30	Roller bearing
32	Roller bearing

No.	Designation
40	Radial seal
42	Radial seal
46	O-ring
47	O-ring
51	Toothed ring
52	Coupling

### Type SC 040 – 100

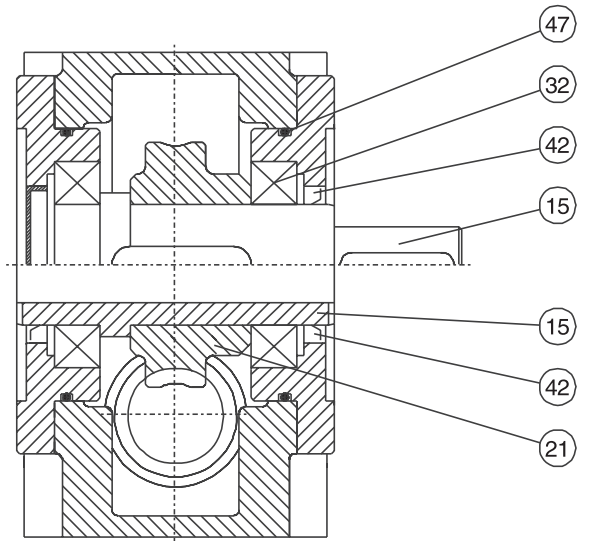
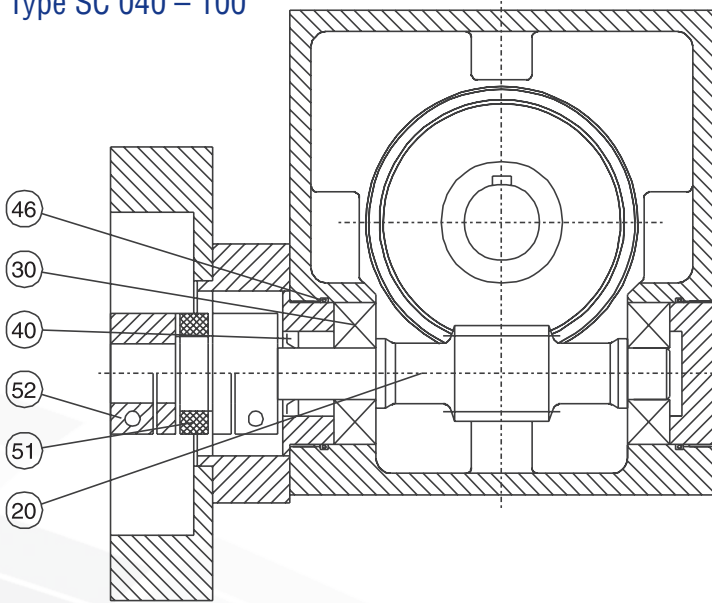

### Type SC 125 – 200

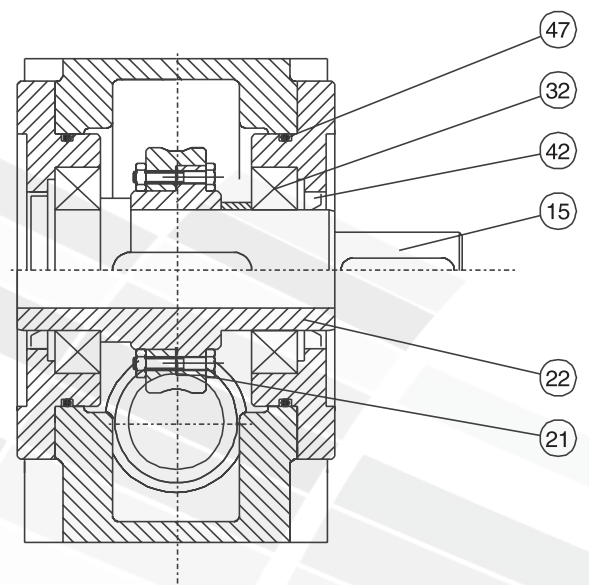
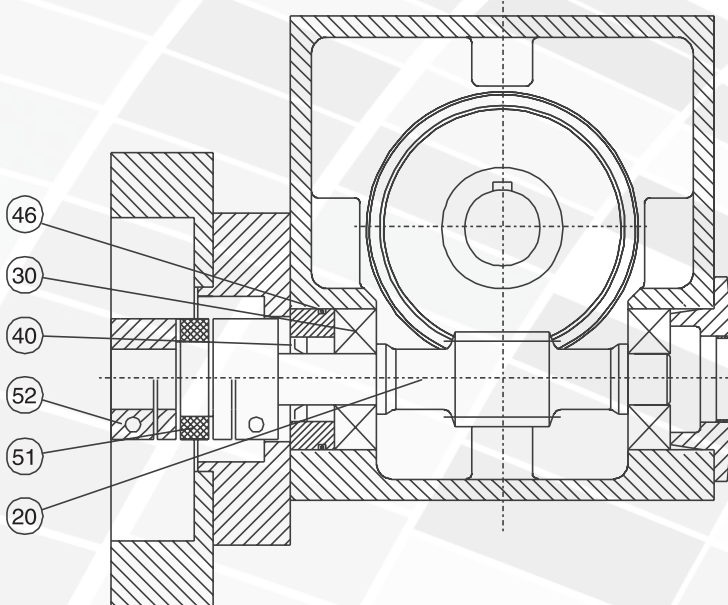

No.	Designation
15	Output shaft
20	Worm
21	Worm gear
22	Hub
30	Roller bearing
32	Roller bearing





No.	Designation
40	Radial seal
42	Radial seal
46	O-ring
47	O-ring
51	Toothed ring
52	Coupling

Service



# 15.4 Lubricant table

If you specify the serial number, you will receive the information on the lubricant quantities from our service department.

Oils	Identifier					
<b>Polyglycol-based synthetic gear oil CLP-PG (not mixable with mineral oil and other synthetic lubricants)</b>	VG 680	Degol GS 680	"Alphasyn GS 680 Optigear Synthetic 800/680"	"Klübersynth GH 6-680	-	Omala S4 WE 680
	VG 460	Degol GS 460	"Alphasyn GS 460 Alphasyn PG 460 Optigear Synthetic 800/460 Optigear Synthetic	"Klübersynth GH 6-460	-	Omala S4 WE 460
	VG 220	Degol GS 220	"Alphasyn GS 220 Alphasyn PG 220 Optigear Synthetic 800/220	"Klübersynth GH 6-220	-	Omala S4 WE 220
	VG 150	-	"Alphasyn PG 150 Optigear Synthetic 800/150"	"Klübersynth GH 6-150	-	
	VG 100	-	Optigear Synthetic 800/100	"Klübersynth GH 6-100	-	
	VG 68	-	-	"Klübersynth	-	
<b>Synthetic gear oils, polyalpha olefins, PAO CLP-HC</b>	VG 460	-	"Alphasyn EP 460 Optigear Synthetic PD 460"	"Klübersynth GEM 4-460 N"	Mobil SHC Gear 460	Omala S4 GX 460
	VG 320	-	"Alphasyn EP 320 Optigear Synthetic PD 320 Optigear Synthetic 1510/320	"Klübersynth GEM 4-320 N	Mobil SHC Gear 320	Omala S4 GX 320
	VG 220	-	"Alphasyn EP 220 Alphasyn HTX 220 Optigear Synthetic PD 220"	"Klübersynth GEM 4-220 N	Mobil SHC Gear 220	Omala S4 GX 220
	VG 150	-	"Alphasyn EP 150 Optigear Synthetic PD 150"	"Klübersynth GEM 4-150 N	Mobil SHC Gear 150	Omala S4 GX 150
<b>Gear oils (mineral oils) CLP</b>	VG 680		"Alpha EP 680 Alpha SP 680 Optigear BM 680 Optigear 1100/680"	"Klüberoil GEM 1-680 N	Mobilgear 600 XP 680	Omala S2 G 680
	VG 460		"Alpha EP 460 Alpha SP 460 Optigear BM 460 Optigear EP 460	"Klüberoil GEM 1-460 N	Mobilgear 600 XP 460	Omala S2 G 460
	VG 320	Degol BG 320	"Alpha EP 320 Alpha SP 320 Optigear BM 320 Optigear EP 320	"Klüberoil GEM 1-320 N	Mobilgear 600 XP 320	Omala S2 G 320
	VG 220	Degol BG 220	"Alpha EP 220 Alpha SP 220 Optigear BM 220 Optigear EP 220	"Klüberoil GEM 1-220 N	Mobilgear 600 XP 220	Omala S2 G 220
	VG 100	Degol BG 100	"Alpha EP 100 Alpha SP 100 Optigear BM 100 Optigear EP 100	"Klüberoil GEM 1-100 N	Mobilgear 600 XP 100	Omala S2 G 100
	VG 68	Degol BG 68	"Alpha EP 68 Alpha SP 68 Optigear BM 68 Optigear EP 68	"Klüberoil GEM 1-68 N	Mobilgear 600 XP 68	Omala S2 G 680
<b>Food-grade gear oils Gear lubricant with NSF-H1 approval CLP CKC</b>	VG 460	-	Optileb GT 460 (PAO) Optileb GT 1800/460 (PG)	"Klüberoil 4 UH1-460 N (CLP HC), Klübersynth	Mobil SHC Cibus 460	-
	VG 220	-	Optileb GT 220 (PAO) Optileb GT 1800/220 (PG)	"Klüberoil 4 UH1-220 N (CLP HC), Klübersynth	Mobil SHC Cibus 220	-
	VG 150	-	Optileb GT 150 (PAO)	"Klüberoil 4 UH1-150 N (CLP HC), Klübersynth	Mobil SHC Cibus 150	-
	VG 68	-		"Klüberoil 4 UH1-68 N (CLP HC)"	--	-
<b>Greases</b>	Identifier					
<b>Lubr. grease</b>	DIN 51825					
-	KP 2 K-30	Aralub HLP 2	Spheerol EPL 2 Tribol GR 400-2 PD Tribol GR 100-2 PD	"Klüberplex BEM 41-132"	Mobilux EP 2	Gadus S2 V220 2 *)
<b>Fluid grease</b>	GP 00 K-30	Aralub LS-EP 00	"Spheerol EPL 00 Tribol GR 100-2 PD Tribol GR 3020/1000-00	"Klübersynth BEM 44-4600"	Mobilith SHC 007 (GPHC00K-30)	Gadus S2 V220 00
<b>Food-grade multi-purpose grease NSF-H1</b>	KHC 2 K-30	-	"Optileb GR UF 1 (KPHC1K-40)"	"Klübersynth UH1 64-62"	"Mobil SHC Polyrex 462 (KPF2P-20)"	-
<b>Food-grade fluid grease NSF-H1</b>	GHC 00 K-30	-	Optileb GR UF 00	"Klübersynth UH1 14-1600, Klüberfood NH1 94-6000	Mobil SHC Polyrex 005 (GPFHC00K-30)	-

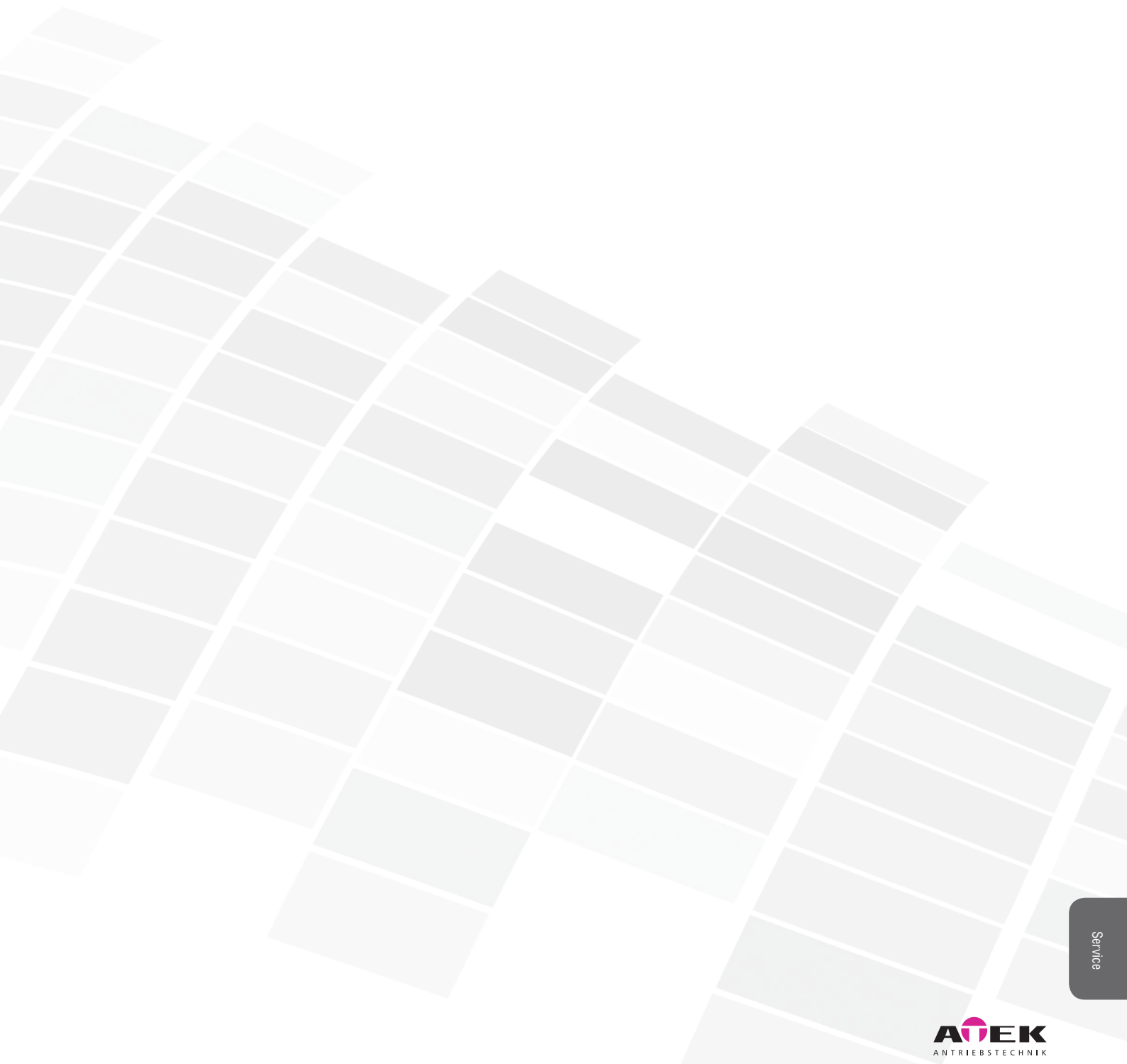

Service





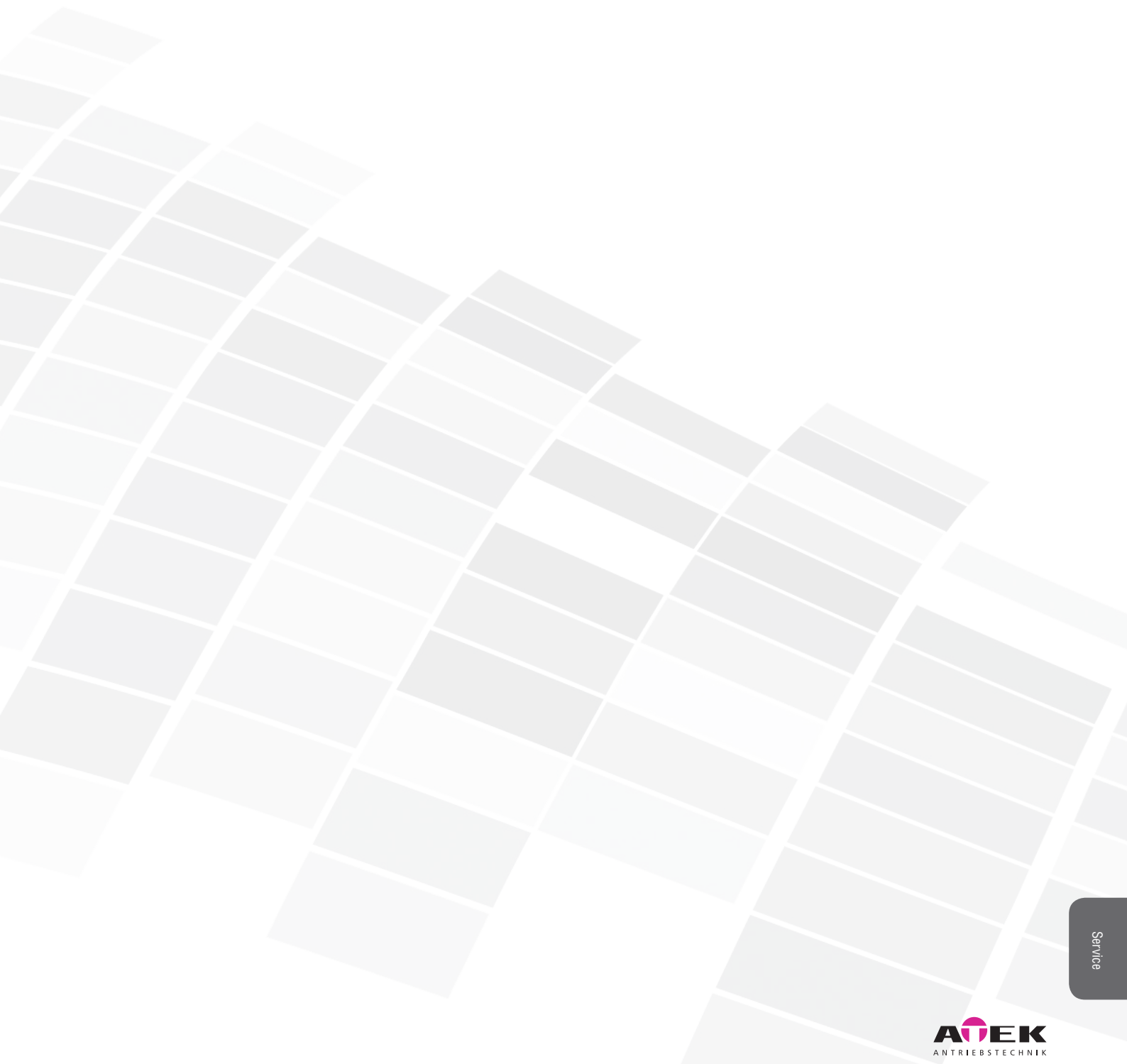

Service

